



10x16 Three Sled Shed

Call toll-free: 1.866.297.3760

Another JCS original, this one is intended for quick and easy access to your favorite toys. We are very pleased to introduce this clever design. Each of the three bays is protected at the entrance with its own single sliding door. This means less jockeying around to get just one thing out. With 160 sq. ft. of usable storage space this building has endless storage possibilities. From your snowmobiles and snow blowers to your motorcycles and lawnmowers, this building can meet your storage needs all year round. Two of the barn doors are hung on the exterior and the middle third is hung on the inside. The traditional barn doors roll easily even in the deepest of snow. This cottage is secured with owner-supplied padlocks. Be advised that the 10' deep model will not fit two person sleds.

Built to withstand our rugged northeastern winters, this beefy heavy duty shed features hefty 2x6 full-dimensioned Hemlock floor and roof framing. All lumber is grown and harvested here in Vermont. Generous roof overhangs offer better protection from the elements while providing the building with attractive trim detail.

Specifications:

Square Footage: 160 sq/ft

Overall Dimensions: 10'6" H x 10'10" W x 17'2" L

Recommended Foundation: 6"-8" of crushed gravel

Floor: Two 6x6x16' Hemlock Skids
 2x6 Hemlock Flooring 24" on center
 3/4" CDX Plywood Flooring

Walls: 85" Front Wall 65" Height Rear Wall Height
 4x4 Post and Beam Wall Framing
 2x6 Rough Hemlock Exposed Collar Ties

Doors: Triple 2" thick JCS built Pine sliding barn doors
 16' long pressure treated ramp

Roof: 2x6 Rafters 24" on center
 10/12 Front roof pitch 6/12 rear roof pitch
 1x4 Strapping 20" on center
 Roofing Corrugated Evergreen Metal 29 gage

Siding: 1" Pine Board & Batten

Trim: 2" Gable Fascia & Shadow
 1" Front & Rear Fascia & Shadow, corner & door trim

Wood Louvered Vent

Overall Weight: 5200 lbs

Cube Size: 42"x58"x192"

Assembly Time: 40 hours

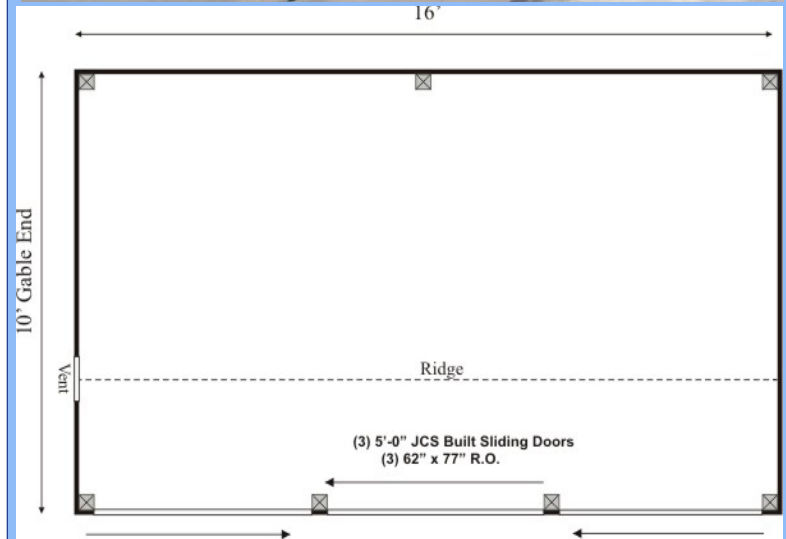

Plans \$50.00

Jamaica Cottage Shop, Inc. engineered the plans for our designs to do-it-yourself homeowners. The detailed plans include foundation options, a shopping list, and a color coded cut list. The trigonometry of the roof triangles has all been simplified with tracing the cut out roof templates. The plans are set for full dimensional lumber and provide a clear step-by-step path.

Fully Assembled \$6,724

Fully assembled from native rough sawn lumber here at our manufacturing facility, this design is delivered to your client prepared, truck accessible site in one piece. The building is set and leveled by our delivery crew and ready to use when we leave your site. Due to road restrictions, fully assembled models are available in the northeastern United States only.